

Maine Geographic Landmarks Scavenger Hunt

Name: _____

Directions: When you find an image in this worksheet on a map, write that map's Letter Clue in the blank (Letter Clue is found on the map's label). The letter clues will be used to break a code.

There are many beautiful places in Maine, and it's no wonder that Maine's nickname is "Vacationland." Find the following geographic landmarks on the maps of Maine.

Part One: Maine's Largest

1. **Mount Katahdin** is Maine's largest mountain at over 5,000 ft elevation. Find this picture of Mt. Katahdin on a map from a geography textbook.



Letter
Clue:

2. The **Kennebec River** is the longest river entirely in Maine. Find this picture of the Kennebec River on a map showing three different northern borders between Maine and Canada.

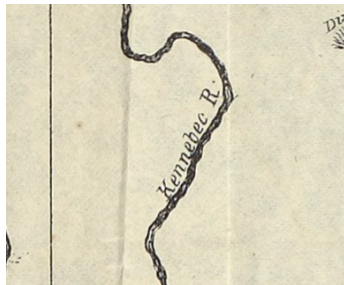

Letter
Clue:

3. **Penobscot Bay** is Maine's largest bay (inlet of water). Find this picture of Penobscot Bay on a map made during the same decade that Maine became a state (1820).



Letter
Clue:

4. **Mt. Desert Island** is Maine's largest island. It's actually the sixth largest island in the entire United States outside of Alaska and Hawaii. Find this picture of Mt. Desert Island on a map made before Maine became a state (which happened in 1820).



Letter
Clue:

5. Maine's largest lake is **Moosehead Lake** at 40 miles long and 20 miles wide. Find this picture of Moosehead Lake on a map that also includes a population chart of the counties.



Letter
Clue:

6. Baxter State Park is the largest *state park* in Maine with over 200,000 acres of land. Find this picture of Baxter State Park on a map that is also a bathmat (hint: it says so along the side).



Letter
Clue:

7. **Acadia National Park** is Maine's largest *national* park with over 47,000 acres of land. Find this picture of Acadia National Park on a map showing pictures about Maine's history.



Letter
Clue:

Part Two: Other Natural Landmarks

8. **Sebago Lake** might not be Maine's largest lake, but it is Maine's deepest lake at over 300 ft deep. In fact, it is the deepest lake in all of New England! Find this picture of Sebago Lake on a map with the "Seal of the State of Maine."



Letter
Clue:

9. Another deep lake (although not as deep as Sebago) in Maine is the **Schoodic Lakes** at 188 ft. deep. Find this picture of Schoodic Lakes on a "County Map of the State of Maine."



Letter
Clue:

10. **St. John River** is an important river in Maine, as it marks Maine's northern border. Find this picture of the St. John River on a map showing proposed highways.



Letter
Clue:

11. **Casco Bay** is not as big as Penobscot Bay, but more people live near it. Find this picture of Casco Bay on a map made before Maine became a state (which happened in 1820).



Letter
Clue:

12. At 22 miles off the coast, **Matinicus Isle** is the inhabited island furthest out to sea in Maine. The population was 53 in 2020. Find this picture of Matinicus Isle on a map from before Maine became a state (which happened in 1820).



Letter
Clue:

Part Three: Biggest Cities

13. **Augusta** - Capital City. Hint: look for a map with blue, pink, and yellow zones.

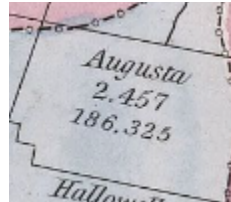

Letter
Clue:

14. **Portland** - Biggest City

Hint: look for a map showing the "Coast, Lake, and Mountain Regions."



Letter
Clue:

15. **Lewiston** - 2nd Biggest City

Hint: look for a map with a hot air balloon.



Letter
Clue:

16. **Bangor** - 3rd Biggest City

Hint: look for a map showing highways in Maine.



Letter
Clue:

17. **Fort Kent** - Biggest Town on Northern Border

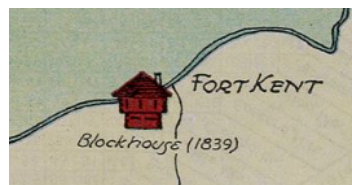

Letter
Clue:

Hint: look for a map with a mermaid in the bottom corner.

**Next: Get the code sheet from the teacher.*

Maine Geographic Landmarks Scavenger Hunt Code Sheet Name: _____

Directions: Use the answers on your scavenger hunt sheet to fill in the missing letters and break the code. For each blank, look at the number underneath and write in the answer to that question number. For example, if you found 'J' for Question 1, you would put 'J' in all the blanks that have a 01 underneath.

M					F				P		C	
04	16	10		07		12	03	02		15	04	02
		M						M				
16	04		02	09	11	16		04	11	16	02	
									F			M
04	06	02	13	02	06	11	01	02	13		06	07
12	03	02	05	04	14	04	16	04	17	11		
			G			G						
15	04	16		08	04		02	09				